



CONDENSOR

The Acclaim Condensor range comprises two models of 500/650w variable beam condensor profile luminaires. The dual condensor optical system provides a very even flat high output beam, making it ideal for pattern (gobo) projection and precise highlighting. Constructed of pressure die-castings and aluminium extrusion, the Acclaim Condensor offers efficiency, strength and performance.

FEATURES

- Superior beam quality and pattern projection from the only dual condensor optic 650w profile on the market.
- Over 30% more light than comparable luminaires.
- Interchangeable lens tray between Medium and Wide.
- Available in 18° - 32° or 24° - 44° beam angles.
- Uniquely shaped shutters offer wider degree of masking angles.
- Adjustable beam Peak-Flat setting.
- Slot provided for Iris or rotatable (35°) Gobo Holder.
- Cranked yoke with adjustable balance point.
- 'Swing-down' doors for easy access to lamp or lens cleaning. Isolates the mains supply when opened.
- Captive lamp/ reflector and lens movement system slides on brass bearing provides smooth focus movement.
- Fully tested and compliant to CE standards

PHOTOMETRIC DATA

Tests conducted using a standard T27, 650w, 240v, 15,000 lumens lamp - average lamp life: 600 hours.

Beam angles:	18° - 32°	24° - 44°
Narrow	50,000cd	25,004cd
Wide	17,860cd	10,716cd

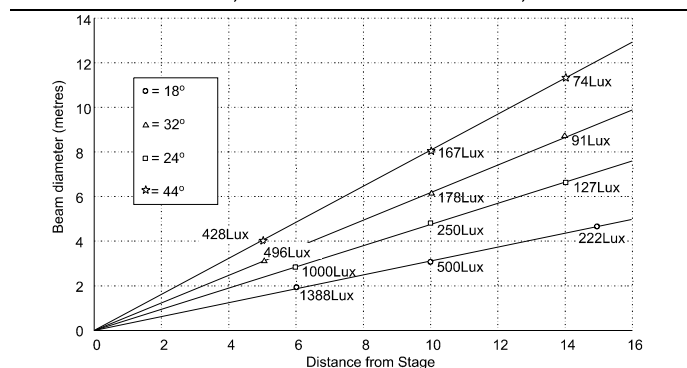

PHYSICAL DATA

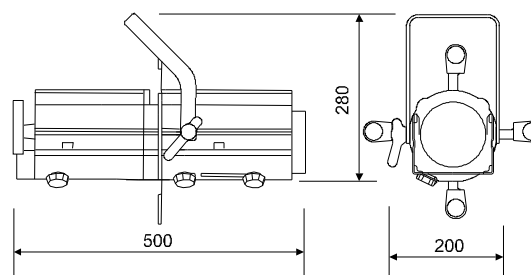

Weight: 5.1 Kg
 Packed Weight: 5.7Kg
 Carton Size: 610 x 225 x 180
 Carton Size Cubic: 0.025
 Colour Frame Size: 125mm x 125mm
 Gobo size: M
 Included: 4 x shutters, 1 x colour frame, 1 x M10 nut & bolt set, instruction sheet

ORDER CODES & ACCESSORIES

Acclaim Condensor 18° - 32°	12ACCPMS
Acclaim Condensor 24° - 44°	12ACCPWMS
Acclaim Iris	15ACIRIS
Acclaim Rotatable Gobo Holder	15ACGH
Acclaim 18° - 32° Lens Tray	15ACLT
Acclaim 24° - 44° Lens Tray	15ACLTW
Lens Safety Mesh	15ACSM
Suspension Hookclamp	20HC
Safety Bond	20SC

Your Selecon Distributor