



FLOOD

The Acclaim Flood provides a 90 degrees even wash of light for stage colour washes and display lighting. 200 - 500w. Supplied with four masking barndoors to shape the beam.

Constructed of Injection moulded Rynite plastic and aluminium extrusion. The Acclaim Cyc offers efficiency, strength and performance.

FEATURES

- Smooth, well controlled beam.
- Dual chamber air flow maximises colour filter life.
- 4 Barndoor flaps provided to shape the beam.
- Dismountable colour filter holder. The filter clamp frame doubles as a template to cut the filter to the right size.
- Constructed from aluminium extrusion and plastic injection moulding.
- Can be assembled into multi battens as for the Cyc range.
- Easy and safe access for relamping and cleaning with hinged safety glass which disconnects the mains supply when opened.
- Fully tested and compliant to CE standards.

PHOTOMETRIC DATA

Tests conducted using a standard R7 118mm double-ended linear lamp, 500w, 240v.

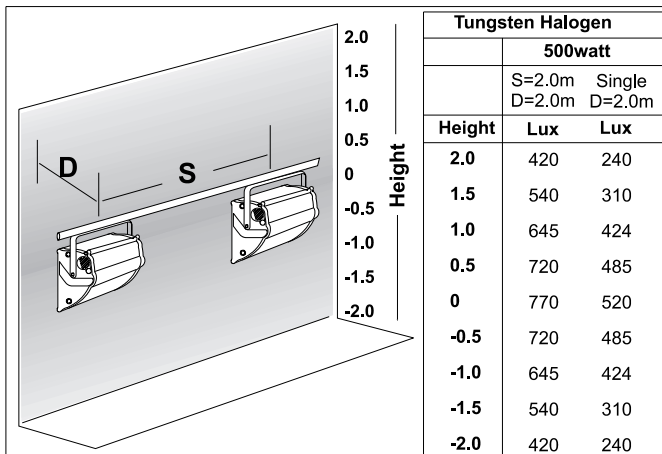

PHYSICAL DATA

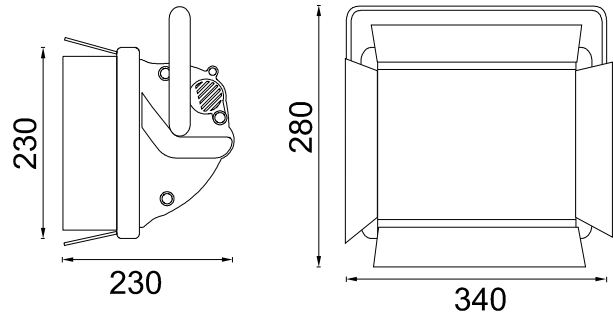

Weight: 2.4 Kg
Packed: 3.3Kg

Packed Size: 226 x 190 x 278

Colour Frame Size: 230mm x 204mm

Included: 1 x colour cassette and frame, 1 x M10 nut & bolt set, 1 x safety glass, instruction sheet.

ORDER CODES & ACCESSORIES

Acclaim Flood	12ACFLOOD
Spare Colour Cassette with Flaps	SAA-AFHWD
Spare Colour frame	SAA-AFSC
Suspension Hookclamp	20HC
Safety Bond	20SC

Your Selecon Distributor